

BUNN®

Silver Series® 2-Flavor

Cold Beverage System

with LED Lighted Graphics and Portion Control Dispense

ITEM# _____

PROJECT _____

DATE _____



JDF-2S

w/Lighted Graphics

Dimensions: 33.1"H x 10"W x 25.5"D
(84.1 cm H x 24.9 cm W x 64.8 cm D)

Features

Cold Beverage System

Cold beverage dispenser with High Intensity® mixing delivers superior drinks consistently glass after glass

- Three-size portion-control dispense.
- LED lighted door graphics bring high visibility to front-of-house applications.
- One dispenser delivers both frozen and ambient products increasing profits by lowering costs.
- Drink consistency assured with the BUNN High Intensity® mixing technology.
- Pumps and mixes 2+1 to 11+1 concentrated beverages, including 4+1 high viscosity and 5+1 juices accurately and consistently.
- Quick dispense with 1.0 to 1.5 ounces (29.6 to 44.4 ml) per second flow rate.
- 7" cup clearance accommodates most juice containers.
- 8 lb. (3.6 kg) ice bank provides superior cold drink capacity.
- Advanced concentrate pump designed for easy setup, accuracy and durability.
- Modular dispense deck makes service fast and simple.
- Preventive maintenance kit: 39690.0000. 

For current specification sheets and other information, go to www.bunn.com.

Related Products

Easy Clear® EQHP-10

Product No. :39000.0004



Ambient Conversion Kit

Product No.: 33699.0001

(one kit required per dispense station - photo shows 4-dispense station unit with one container and three ambient conversion kits)



Easy Clear® EQHP-10CRTG

Product No. :39000.1004

Extended Drip Tray (JDF-2S)

Product No. :44015.1000

*increases cup clearance to 10.25"
(grill not included, use existing grill or order 26801.0000 below)*



Refillable Juice Container

Capacity: 1 Gallon

Product No.: 39302.0000



Portion Control Membrane Switch Kit

Product No. :41298.0000

Push-Hold Membrane Switch Kit

Product No. :41299.0000

Replacement Grill fits Standard and Extended Drip Trays (JDF-2S)

Product No. :26801.0000

Model

JDF-2S

Agency Listing



Dimensions & Specifications

| Model | Product # | Volts | Amps | Capacity | Cubic Measure | Shipping Weight | Cord Attached |
|--|------------|-------|------|-----------------------|----------------------|-----------------|------------------|
| JDF-2S, Lit Door <i>(portion control, juice display)</i> | 37900.0016 | 120 | 4.5 | 4 (5 oz.) drinks/min* | 10.3 ft ³ | 103 lbs. | Yes [†] |
| JDF-2S, Lit Door <i>((dual dispense - allows simultaneous dispense from both dispense heads, portion control, juice display))</i> | 37900.0026 | 120 | 4.5 | 4 (5 oz.) drinks/min* | 10.3 ft ³ | 103 lbs. | Yes [†] |

Refillable Juice Container Product No.: 39302.0000 Capacity: 1 Gallon (sold separately)

* 75°F (24°C) incoming water for 180 drinks without exceeding 41°F (5°C) finished drink temperature.

[†]Power cord (NEMA 5-15P) 15 Amp-120V machine only.

Electrical: Model requires 2-wire grounded service rated 120V, single phase, 60 Hz.

Plumbing: 20-100 psi (138 - 690 kPa). Machine supplied with $\frac{3}{8}$ " (0.95 cm) male fitting.

Refrigeration: R-134a refrigerant, 9 oz. (.28 kg), 8 lb. (3.6 kg) ice bank system

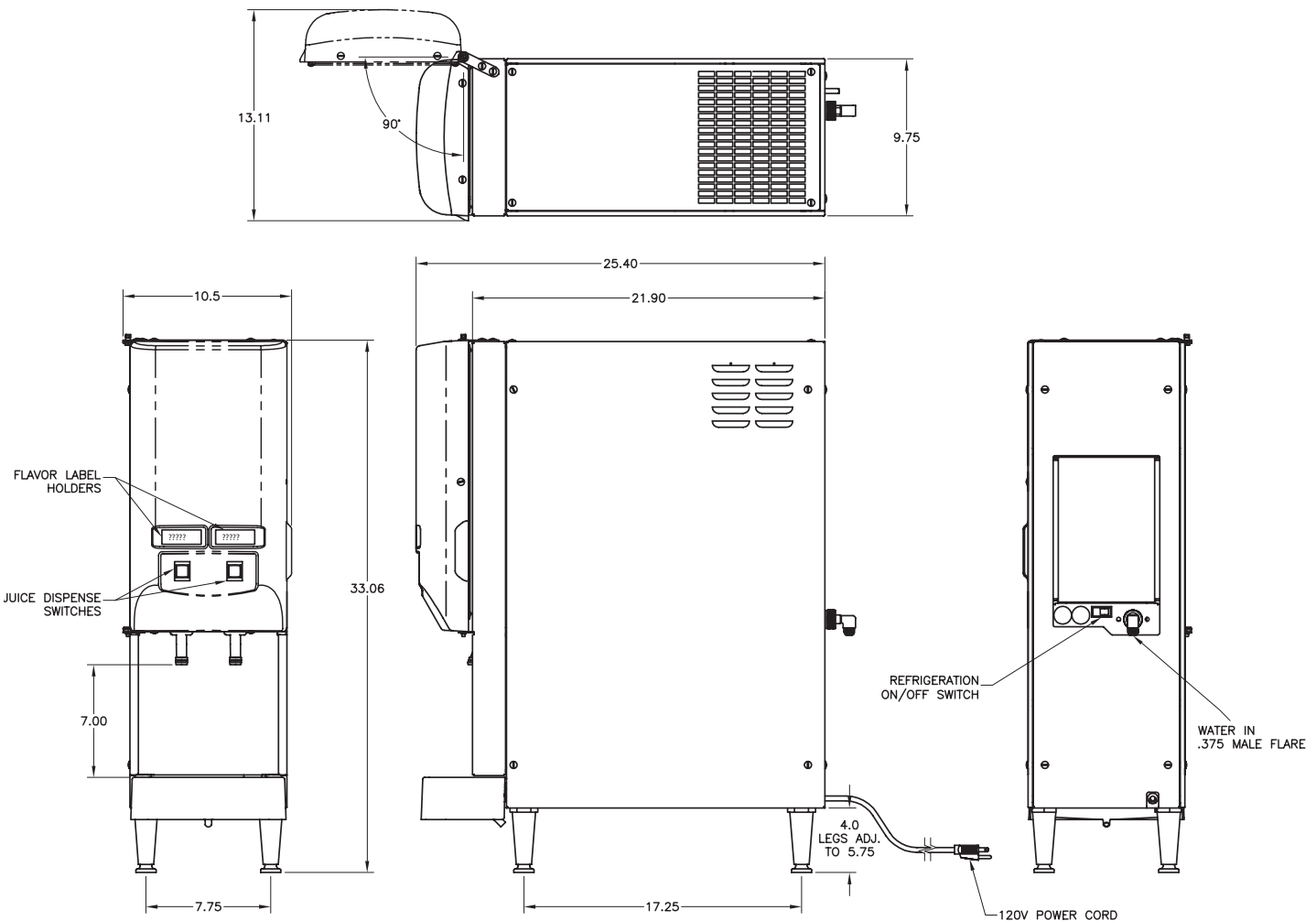

Bunn-O-Matic® Corporation - 1400 Stevenson Drive Springfield, Illinois 62703 • 800-637-8606 • 217-529-6601 • Fax 217-529-6644 • www.bunn.com

BUNN® practices continuous product research and improvement. We reserve the right to change specifications and product design without notice. Such revisions do not entitle the buyer to corresponding changes, improvements, additions or replacements for previously purchased equipment.

All dimensions shown in inches.

4/12 © Bunn-O-Matic Corporation